

Selecting Power Source with Dual Battery System

When the extended range battery pack is installed and sufficiently charged, the bike will utilize this battery as the primary power source. The icon near the battery life indicator on the display will show "B2" to indicate that the extended range battery pack is being used. Once the power of the extended range battery pack is exhausted, you can change the power source of the bike to the main battery pack by double-clicking the power button. The battery icon on the display will show "B1" to indicate that the main battery pack is now being used. At any time you can toggle between the batteries to change the power source or to check the battery level by double-clicking the power button.

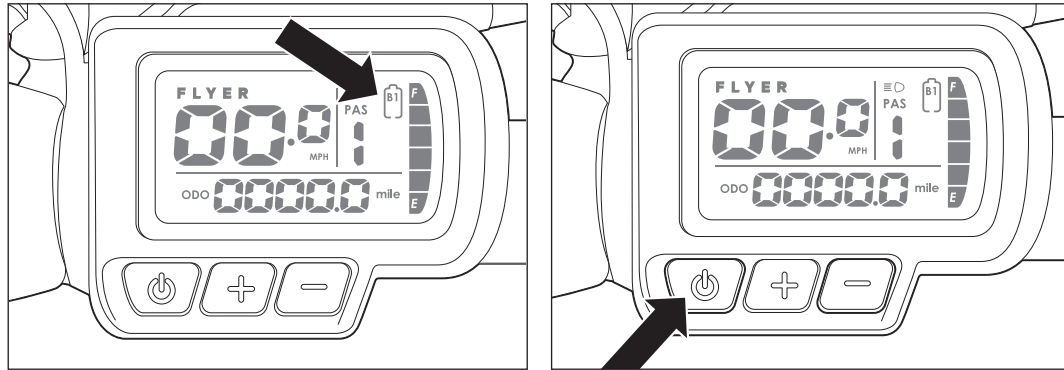

Checking Battery Charge Level via Integrated LED Indicator

- Locate the battery life indicator on the side of the battery pack.
- Push the button on the battery fuel gauge. Fuel gauge LEDs will light up corresponding to the level of charge in the battery pack.

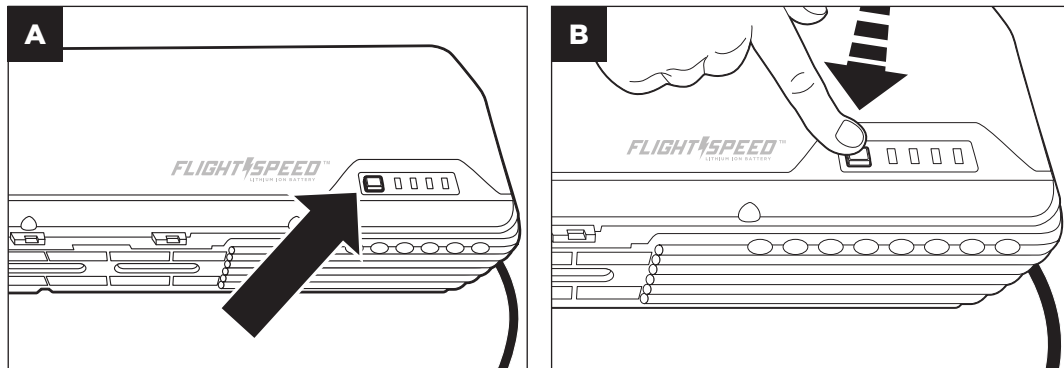

Moving & Storing

- Always remove the battery from the eBike before transporting the bicycle on a vehicle bike rack.
- The eBike should be stored indoors when not in use. Failure to do so may cause additional wear on the eBike, which is not covered under warranty.
- Store the battery in a dry location.
- If the eBike will not be used for an extended period, do not store the battery installed in the eBike.
- To maintain battery life, you must charge every 6 months.
- When not using the battery for an extended period, charge the battery to at least 75%.
- Do not store the battery in locations where the temperature is below 14°F (-10°C) or above 104°F (40°C)

Battery Recycling

- Keep battery and charger in a dry place out of reach of children.
- Recycle battery and charger in an environmentally friendly manner.
- Do not dispose of your battery in a fire as the battery may catch fire or explode.
- Do not dispose of your battery in your regular household trash. The incineration, landfilling, or mixing of batteries with household trash is prohibited by law in most areas.
- Return an exhausted battery to a federal or state approved recycler. Contact your local waste management officials for other information regarding the environmentally sound collection, recycling, and disposal of batteries.

Warranty

The full warranty policy is available at <https://flyer.radioflyer.com/warranty-policy>. If you have questions regarding the warranty policy or to initiate a warranty claim, please contact the Radio Flyer Customer Service team by email at customerservice@radioflyer.com or by phone at 1-800-621-7613.



Flight Speed™ Extended Range Battery Instruction Sheet Model #AC810

Compatibility: Flyer™ L885

Battery and Charger Safety Warnings

⚠ WARNING! TO PREVENT FIRE, EXPLOSIONS, OR ELECTRIC SHOCK:

- Before using the battery read all instructions and cautionary markings on the charger and battery pack.
- Only use the specified Flyer™ charger to charge this battery. Do not attempt to charge with any other chargers. Replacement chargers are available to purchase exclusively at flyer.radioflyer.com or by calling Radio Flyer Customer Service at 1-800-621-7613.
- Do not store the battery in locations where the temperature is below 14°F (-10°C) or above 104°F (40°C)
- Do not charge the battery in temperatures below 32°F (0°C) or above 104°F (40°C) as it will cause damage to the battery pack.
- Do not operate the charger or battery if it has been impacted, dropped, or damaged in any way.
- Do not use if the power cord is frayed, has broken insulation, or any other signs of damage.
- If the plastic on the battery breaks or cracks, stop use and call Radio Flyer Customer Service.
- Examine the charger and battery before each use and replace if wear or damage is found.
- Do not incinerate the battery pack. The battery can explode in a fire.
- Never attempt to open or disassemble the battery pack or charger for any reason. Do not puncture the battery.
- To prevent electric shock, do not immerse the charger or battery in water. Do not attempt to charge if the cord or power adapter is wet.
- To clean, remove the charger/battery plug from the outlet and wipe with a dry cloth.
- During charging, the battery must be placed in a dry ventilated area.
- Do not place any object on top of the charger or place the charger on a soft surface that may result in excessive heat. Place the charger away from any heat sources.
- The charger is designed to operate on a standard household electrical power (110/120 VDC). Do not attempt to use the charger on any other voltage level.
- To reduce the risk of fire, connect only to a circuit provided with 15 amperes maximum branch circuit overcurrent protection in accordance with the National Electrical Code, ANSI/NFPA 70.
- When charging is complete, disconnect the charger from the wall outlet and the battery.
- Place the battery and charger in a place out of reach from children.
- To increase battery life, recharge after every use.
- To maintain battery life, you must charge every 6 months.

Assembly

The following steps provide a general overview of the assembly process for your Flight Speed™ Extended Range Battery. Visit flyer.radioflyer.com or contact customerservice@radioflyer.com for additional assistance assembling, using, repairing or maintaining your battery pack.

Tools

4mm Allen Wrench



Unpack Your Battery

Remove the battery pack from the outer carton and discard all protective packaging. Verify that you have all of the components listed below. Contact Radio Flyer Customer Service if any components are missing.

Flight Speed™ Extended Range Battery Pack
Battery Dock
Keys
M5 x12mm Attachment Screws

Assemble the Battery Dock

- Align the battery dock with the mounting holes on the bike frame.
- Using a 4mm allen wrench, install the three attachment screws. Tighten all screws to 5Nm.

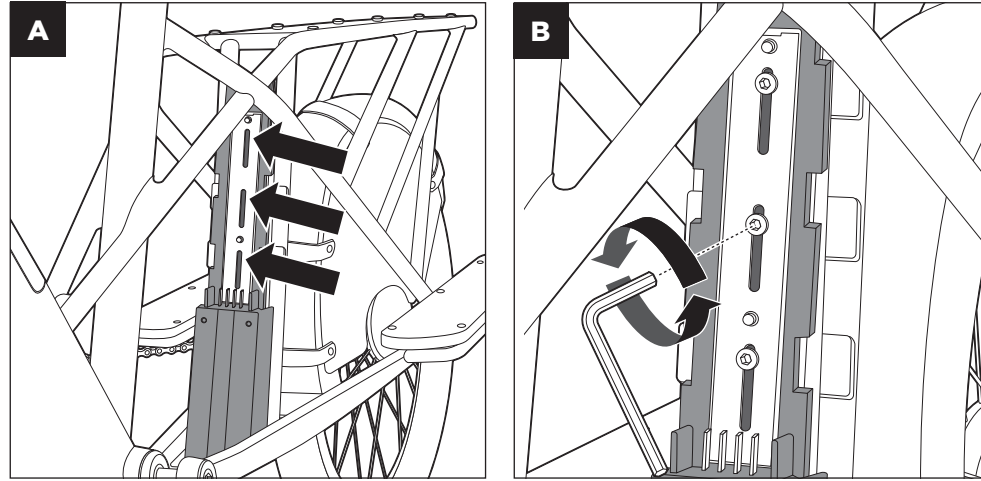

Install the Battery Pack on the Dock

- Load the battery pack onto the dock by feeding it up through the rear frame.
- Align the battery pack with the tabs on the dock. Press down firmly on the pack to connect the battery to the dock terminals.
- Lock the battery to the dock using the provided keys.

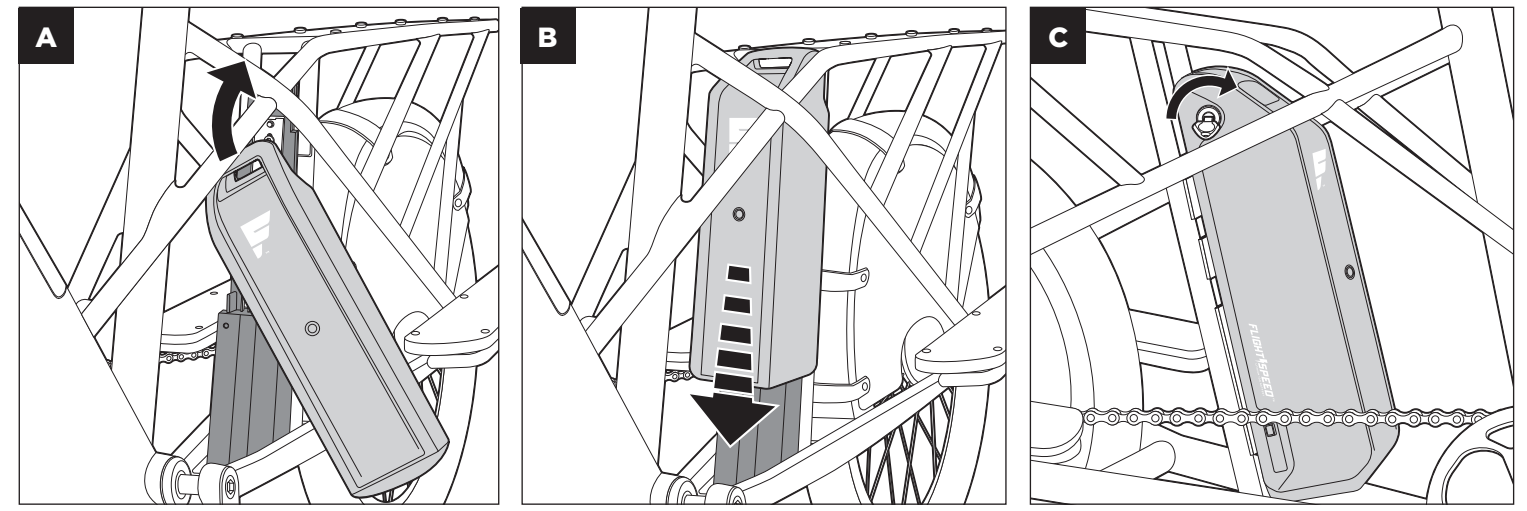

Warning! Ensure extended range battery is locked before riding. An unlocked battery can endanger rider and other vehicles.

Operating Instructions

Connect Battery Dock Wire Harness

- Remove the protective rubber cover from the battery dock wire harness.
- Locate the dock connection wire harness on the bike frame and remove the waterproof cover.
- Slide the connectors together, pushing firmly to ensure a solid connection.

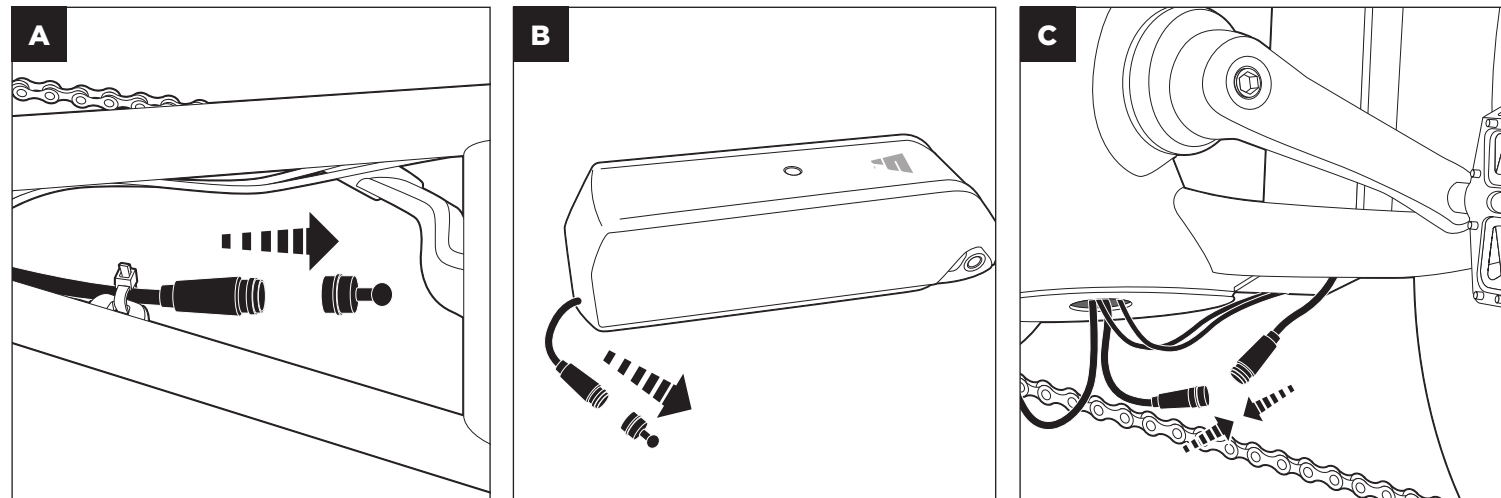

Charging the Battery

The Flight Speed™ battery can be charged while installed in the bike or when removed from the bike frame.

- Ensure the battery is off by powering off the display as described in the “Handlebar Display” section above.
- Remove the rubber cover to reveal the battery charging port.
- Plug the charger into the battery charging port, ensuring the terminals are properly aligned with the port. Push the charger plug firmly into the charging port.
- Plug the charger into a power outlet. Only connect your charger to an outlet with a rated voltage of 110-220VAC. The LED in the charger housing will turn red to indicate the charger is connected properly.
- The charger LED will turn green when the battery is fully charged. When LED turns green, unplug the charger from the power outlet.
- Unplug the charger plug from the charging port and securely replace the rubber cover.

